

SLV 203025 Recreation module

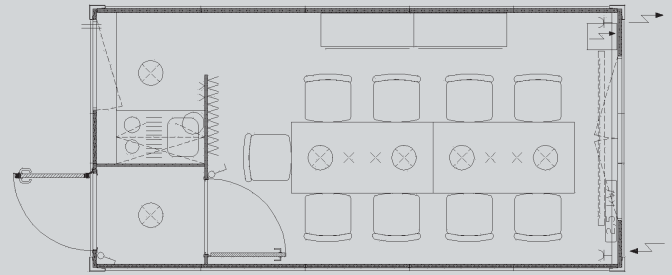

SLV 203025 Conference module

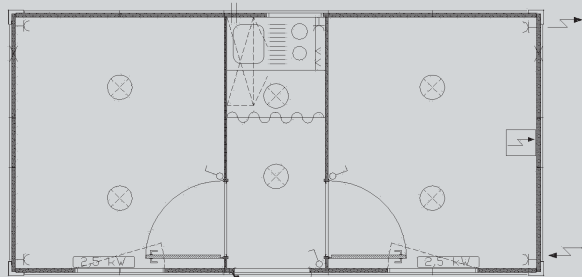

SLV 203025 Trade-fair module

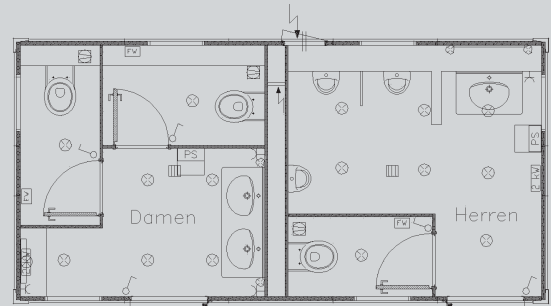

SLV 203025 Sanitary module

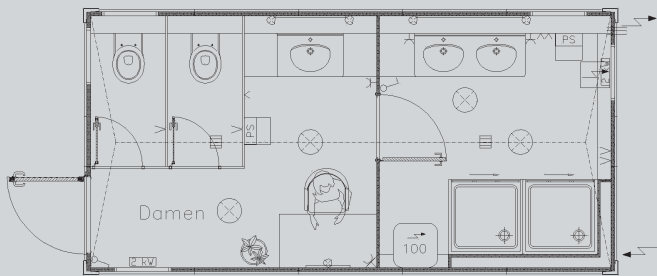

SLV 203025 Toilet/shower module, ladies

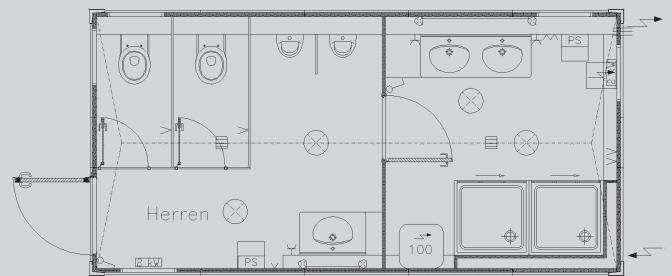

SLV 203025 Toilet/shower module, gentlemen

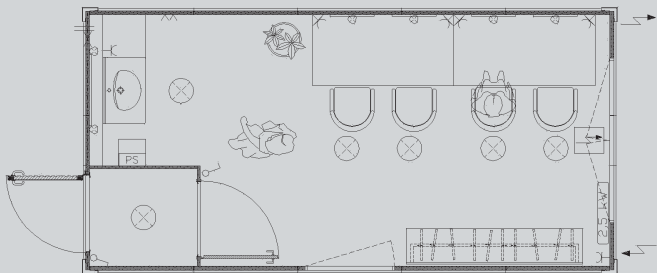

SLV 203025 Changing room module



# OECON SILVER-LINE

## SILVER-LINE

Tried-and-tested OECON technology in a new design

SILVER-LINE modular building units are solutions with a system from top to bottom. The electrically welded cantilever steel

frame made of fully galvanized special sections provides the sturdy basis for the durable OECON technology.

This quality is the prerequisite for genuinely variable rooms: delivered as a single room today, and part of a system in a multi-storey build-

ing, a large complex or an impressive office building tomorrow. Made to measure, with all the requisite detail features – including transport and assembly.

**Wherever you want ...  
... whenever you want.**

## Standard type (Basic price)

### Frameworks

Cantilever, electrically welded steel frame made of zinc-coated special profiles, with 8 corner fittings made of high strength steel casting according to ISO 1161. Twofold stackable in standard version.

### Floor

Zinc coated I-crossbeam with overlying sandwich-floor, thickness 60 mm, aligned to the floor frame. Body: zinc coated steel plate, PUR hard foam core, CFC-free, under pressure foamed, premium chipboard, thickness 22 mm, V100 E0 (formaldehyde free!), with special edge protection. Continuous isolation above the steel frame, to prevent thermal heat bridges. Allowed working load in the first floor. 2,0 kN/sqm, allowed snow load 0,71 kN/sqm. Special homogeneous PVC-floor-covering with plastic-covered skirting. Non-slip PVC-floor in moisture-area prone.

### Exterior walls

OECON-Sandwich elements with PUR hard foam core, CFC-free, individually replaceable and exchangeable both frontal and lengthwise, interconnected with outside lying alloy profiles. To link-up the containers all wall-elements may be dismantled frontal and lengthwise. Silver coloured outer facade with mini-corrugations.

### Interior walls

Inner casing made of MDF- decorative plates with plastic pattern; in damp locations using special panels. The outer and inner casing are pressure and push resistant interconnected to the hard foam core without using screws or welding spots. Ventilation with protection against insects.

### External doors

In sandwich construction, dimension 201 x 88,5 cm. Door frame made of alloy profiles with integrated rubber sealing, alloy hinges and door handle profile-cylinders with 2 keys.

### Roof/ceiling

OECON-Sandwich elements, thickness 67 mm, surface made of Pantex plates, covered with white plastics. PUR hard foam core insulation, CFC-free. Detached rectangular grid-roof with integrated grid-lights. Suspended ceiling height: approx. 15 cm.

### Coating

2-Component-coating, silver (RAL 9006 , white aluminium).

### Dimensions (Basic module):

<b>Outside dimensions:</b>	SLV 203025
Length	6.055 mm
Width	3.000 mm
Height	2.810 mm
<b>Inside dimensions:</b>	
Length	5.890 mm
Width	2.830 mm
Height	2.500 mm
Effective area, appr.	17.00 qm

### Windows

Plastic windows available as bottom hung- skylight- or sliding window.

### Electrics

Installation according to VDE / DIN. In wall wiring using existent cable channel respectively using the outer wall and ceiling element joints. Sockets, switches, fuse box and splash-proof on-wall CEE-outer connectors.

### Heating

Electric-heaters.

### Sanitary- / Gas installation

Installation according to DIN resp. DVGW/ DVG.

### Possible equipment (additional charge)

#### Floor

Floor backing, additional insulations, various floor-coverings, floor pans and EDP-false floors.

#### Roof

Roof backings, roof systems, additional insulation, sun canopies, attic faceplate, landscaped roof.

#### Coating

Special coating on demand. Special models and outfits on demand.

# OECON SILVER-LINE

The OECON SILVER-LINE is a customizable accommodation miracle. With its distinctive silver outer facade, the SILVER-LINE meets all the requirements of a modern, mobile modular building system.

In the OECON SILVER-LINE, even the outside walls do not have a load-bearing function. The sandwich wall elements in a panel design with the high-quality insulating core of CFC-free rigid PUR foam can be individually dis-

assembled, exchanged or removed from units joined end-to-end or side-by-side. Nothing is impossible!